

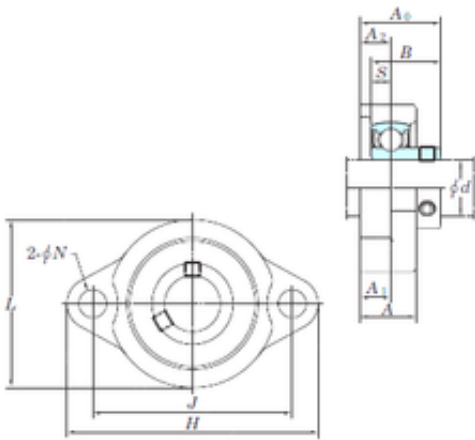

KOYO BLF205 bearing units

Bearing No. BLF205



BLF205 Bearing 2D drawings and 3D CAD models

Bore Diameter	25 mm
d	25 mm
A0	30,5 mm
A	20 mm
A1	11 mm
B	27 mm
H	95 mm
J	76 mm
L	64 mm
N	10 mm
S	7,5 mm
Bolt (G)	M8
A2	11 mm
Weight	0,38 Kg
Basic dynamic load rating (C)	14 kN
Basic static load rating (C0)	7,85 kN
Bearing No.	BLF205
Bolt size	M8
Cr	14.0
C0r	7.85
f0	13.9
(Refer.)Unit mass(kg)	0.38